

Plotted By: Lanier, Morgan Sheet: K610 Layout: 06.0 March 08, 2019 02:29:46pm K:\VLD\Civil\067800501 - Triad Gosling Retail\DWG\PlanSheets\C-06.dwg
 This document, together with the concepts and designs presented herein, is intended only for the specific purpose and client for which it was prepared. Reuse of and improper reliance on this document without written authorization and adaptation by Kimley-Horn and Associates, Inc. shall be without liability to Kimley-Horn and Associates, Inc.

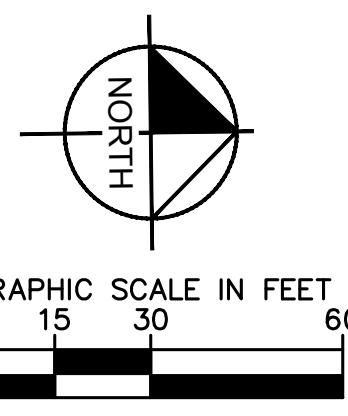
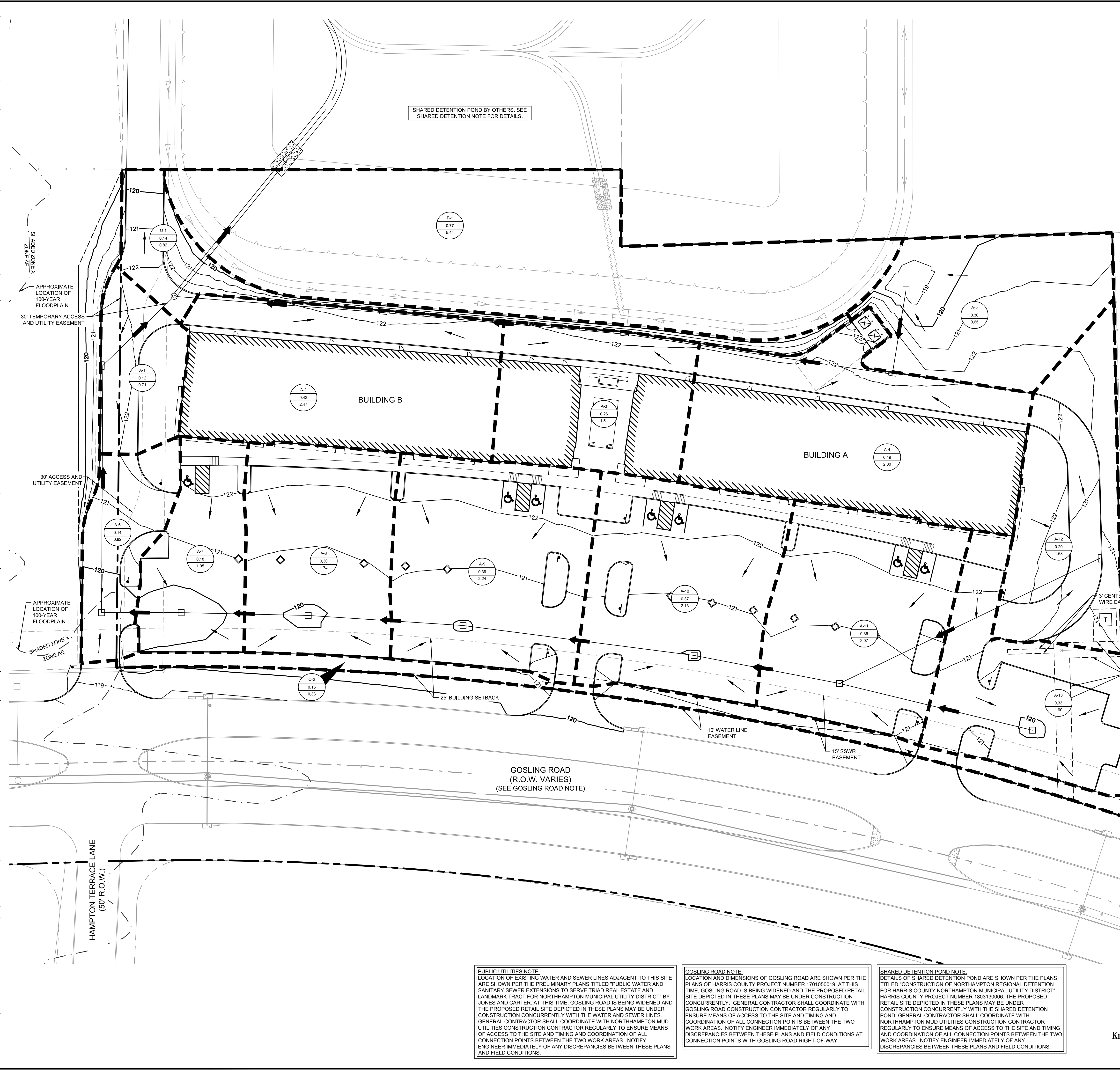

LEGEND

- A-1
0.12
0.71 DRAINAGE AREA NUMBER
- DRAINAGE AREA (ACRES)
- FLOW (CFS) 100-YR
- PROPOSED CONTOUR ELEVATIONS
- DRAINAGE AREA
- FLOW ARROW
- 100-YR EXTREME EVENT FLOW PATH

DA #	A (AC)	C	TC (min)	STORM OUTFALL				
				2-Year		100-Year		
				I-2 (IN/HR)	Q-2 (CFS)	I-100 (IN/HR)	Q-100 (CFS)	
A-1	0.12	0.8	21.88	3.64	0.35	7.38	0.71	
A-2	0.43	0.8	23.62	3.50	1.21	7.17	2.47	
A-3	0.26	0.8	22.89	3.56	0.74	7.26	1.51	
A-4	0.49	0.8	23.82	3.49	1.37	7.14	2.80	
A-5	0.30	0.3	23.09	3.54	0.32	7.23	0.65	
A-6	0.14	0.8	22.07	3.62	0.41	7.36	0.82	
A-7	0.18	0.8	22.39	3.60	0.52	7.32	1.05	
A-8	0.30	0.8	23.09	3.54	0.85	7.23	1.74	
A-9	0.39	0.8	23.47	3.52	1.10	7.18	2.24	
A-10	0.37	0.8	23.39	3.52	1.04	7.19	2.13	
A-11	0.36	0.8	23.35	3.52	1.01	7.20	2.07	
A-12	0.29	0.8	23.04	3.55	0.82	7.24	1.68	
A-13	0.33	0.8	23.23	3.53	0.93	7.21	1.90	
O-1	0.14	0.8	22.07	3.62	0.41	7.36	0.82	
O-2	0.15	0.3	22.16	3.62	0.16	7.35	0.33	
P-1	0.77	1.0	24.55	3.44	2.65	7.06	5.44	
TOTAL PROPOSED							Q-100	28.37

BASE FLOOD ELEVATION NOTE:
 THIS SITE IS LOCATED WITHIN SHADED ZONE "X" PER FEMA FIRM MAP NUMBER 48201C0255M DATED OCTOBER 16, 2013.

PUBLIC UTILITIES NOTE:
 LOCATION OF EXISTING WATER AND SEWER LINES ADJACENT TO THIS SITE ARE SHOWN PER THE PRELIMINARY PLANS TITLED "PUBLIC WATER AND SANITARY SEWER EXTENSIONS TO SERVE TRIAD REAL ESTATE AND LANDMARK TRACT FOR NORTH HAMPTON MUNICIPAL UTILITY DISTRICT" BY JONES AND CARTER. AT THIS TIME, GOSLING ROAD IS BEING WIDENED AND THE PROPOSED RETAIL SITE DEPICTED IN THESE PLANS MAY BE UNDER CONSTRUCTION CONCURRENTLY WITH THE WATER AND SEWER LINES. GENERAL CONTRACTOR SHALL COORDINATE WITH NORTH HAMPTON MUD UTILITIES CONSTRUCTION CONTRACTOR REGULARLY TO ENSURE MEANS OF ACCESS TO THE SITE AND TIMING AND COORDINATION OF ALL CONNECTION POINTS BETWEEN THE TWO WORK AREAS. NOTIFY ENGINEER IMMEDIATELY OF ANY DISCREPANCIES BETWEEN THESE PLANS AND FIELD CONDITIONS.

GOSLING ROAD NOTE:
 LOCATION AND DIMENSIONS OF GOSLING ROAD ARE SHOWN PER THE PLANS OF HARRIS COUNTY PROJECT NUMBER 1701050019. AT THIS TIME, GOSLING ROAD IS BEING WIDENED AND THE PROPOSED RETAIL SITE DEPICTED IN THESE PLANS MAY BE UNDER CONSTRUCTION CONCURRENTLY. GENERAL CONTRACTOR SHALL COORDINATE WITH GOSLING ROAD CONSTRUCTION CONTRACTOR REGULARLY TO ENSURE MEANS OF ACCESS TO THE SITE AND TIMING AND COORDINATION OF ALL CONNECTION POINTS BETWEEN THE TWO WORK AREAS. NOTIFY ENGINEER IMMEDIATELY OF ANY DISCREPANCIES BETWEEN THESE PLANS AND FIELD CONDITIONS.

SHARED DETENTION POND NOTE:
 DETAILS OF SHARED DETENTION POND ARE SHOWN PER THE PLANS TITLED "CONSTRUCTION OF NORTH HAMPTON REGIONAL DETENTION POND FOR HARRIS COUNTY NORTH HAMPTON MUNICIPAL UTILITY DISTRICT", HARRIS COUNTY PROJECT NUMBER 1803130006. THE PROPOSED RETAIL SITE DEPICTED IN THESE PLANS MAY BE UNDER CONSTRUCTION CONCURRENTLY WITH THE SHARED DETENTION POND. GENERAL CONTRACTOR SHALL COORDINATE WITH NORTH HAMPTON MUD UTILITIES CONSTRUCTION CONTRACTOR REGULARLY TO ENSURE MEANS OF ACCESS TO THE SITE AND TIMING AND COORDINATION OF ALL CONNECTION POINTS BETWEEN THE TWO WORK AREAS. NOTIFY ENGINEER IMMEDIATELY OF ANY DISCREPANCIES BETWEEN THESE PLANS AND FIELD CONDITIONS.

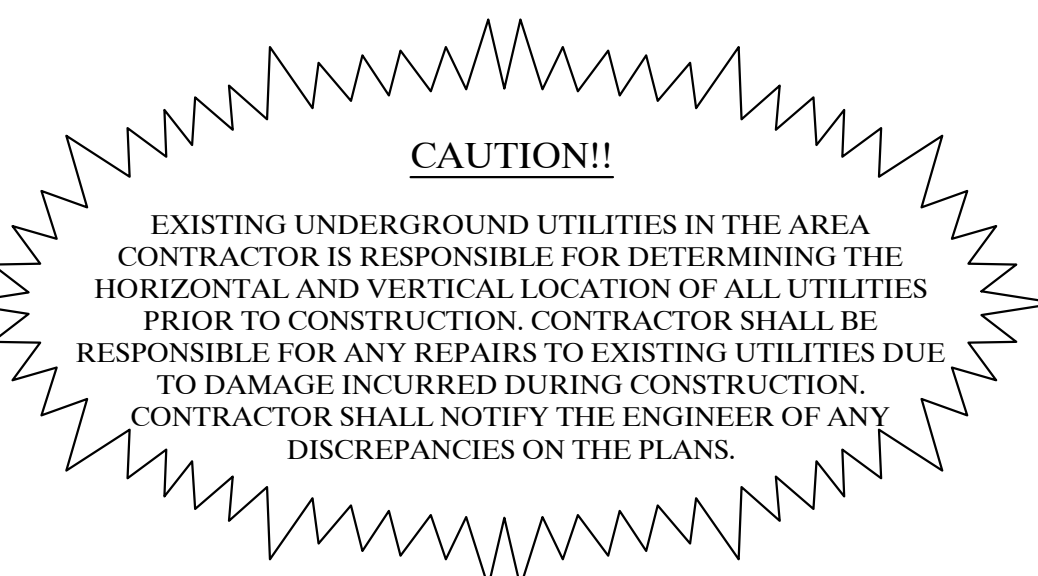

No.	REVISIONS	DATE	BY

Kimley»Horn

© 2017 KIMLEY-HORN AND ASSOCIATES, INC.
 1400 WOODLICK FOREST DRIVE, SUITE 225
 HOUSTON, TEXAS 77057-3630
 PHONE: 281.724.2416
 TBE FIRM REGISTRATION F-928
 WWW.KIMLEY-HORN.COM



KHA PROJECT	067800501
DATE	03/08/2019
SCALE	AS SHOWN
DESIGNED BY	SLH
DRAWN BY	MTL
CHECKED BY	SCF

**PROPOSED
 DRAINAGE AREA MAP**

**TRIAD GOSLING RETAIL
 HARRIS COUNTY
 TEXAS**

SHEET NUMBER
C6.0