

Plotted By: Mundy, Shannon Sheet: Set: KHA Layout: L2.0 March 11, 2019 01:47:42pm K:\VHOU_LALP_VLD_Support_Woodlands_Sheets_VLD.dwg User: VLD Date: 3/11/2019 1:47:42 PM
 This document, together with the concepts and designs presented herein, is intended only for the specific purpose and client for which it was prepared. Reuse of and improper reliance on this document without written authorization and adaptation by Kimley-Horn and Associates, Inc. shall be without liability to Kimley-Horn and Associates, Inc.

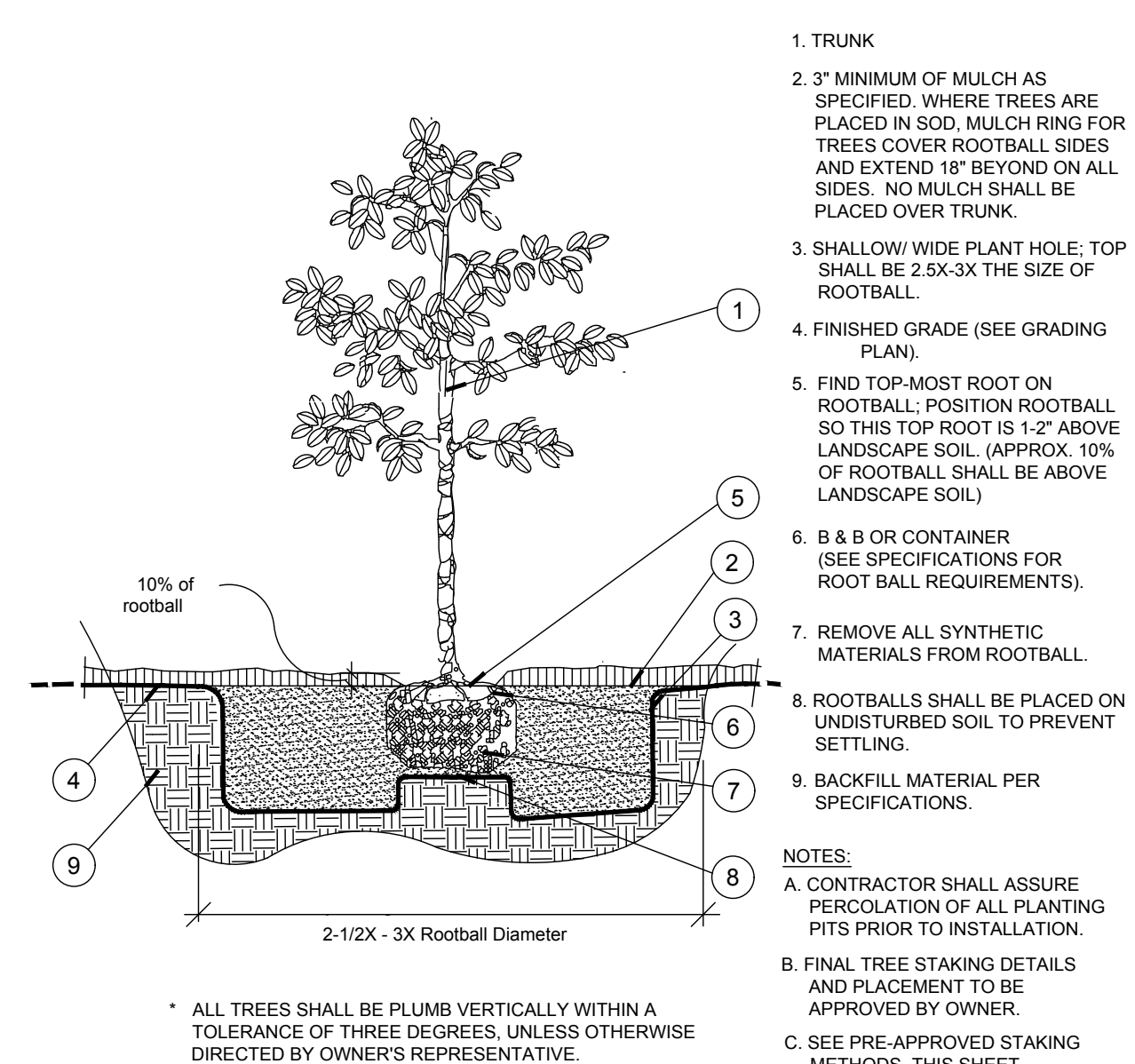

A Tree Planting
SECTION N.T.S.

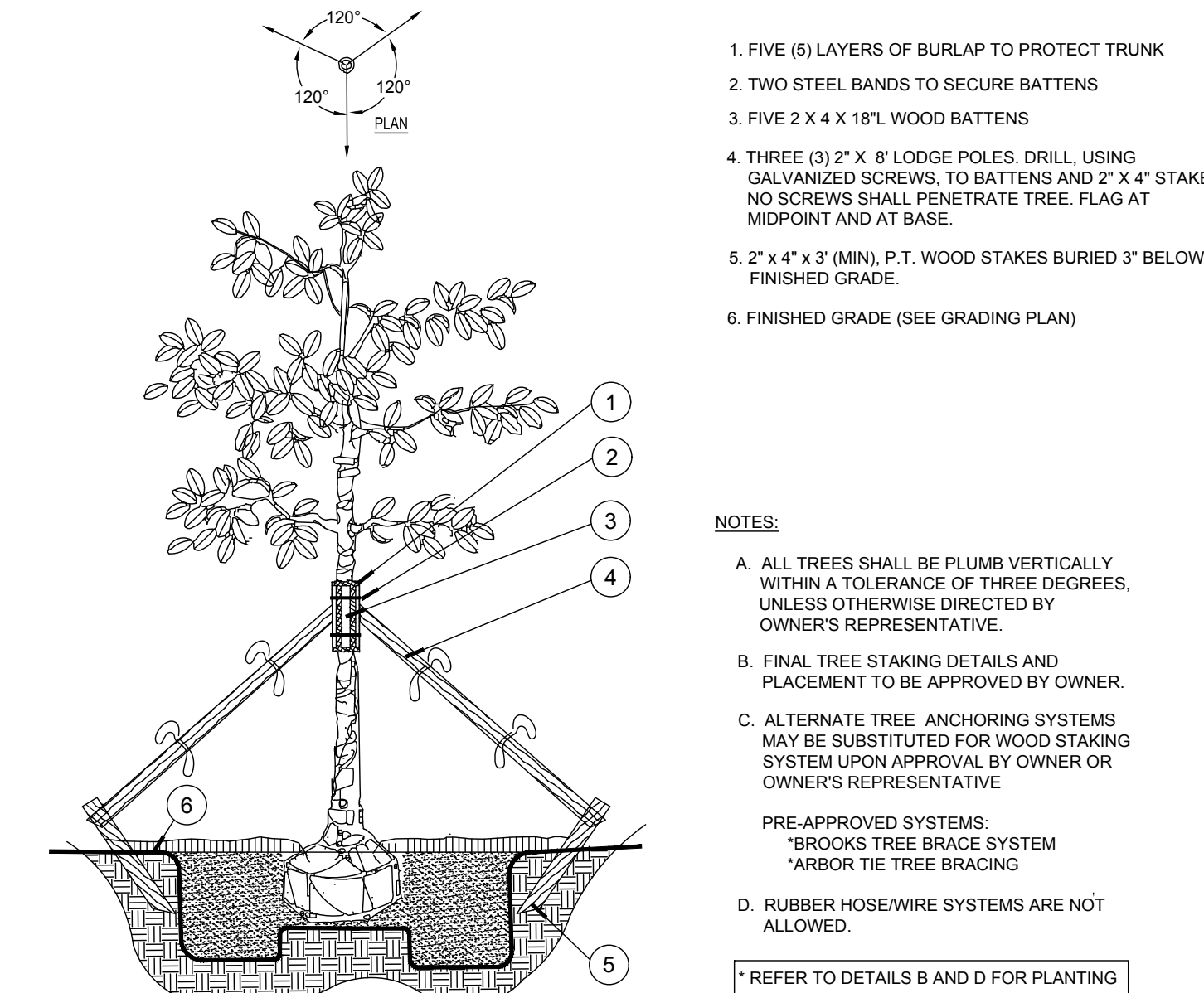

B Large Tree Staking - 100 Gal + or B&B 4\"/>

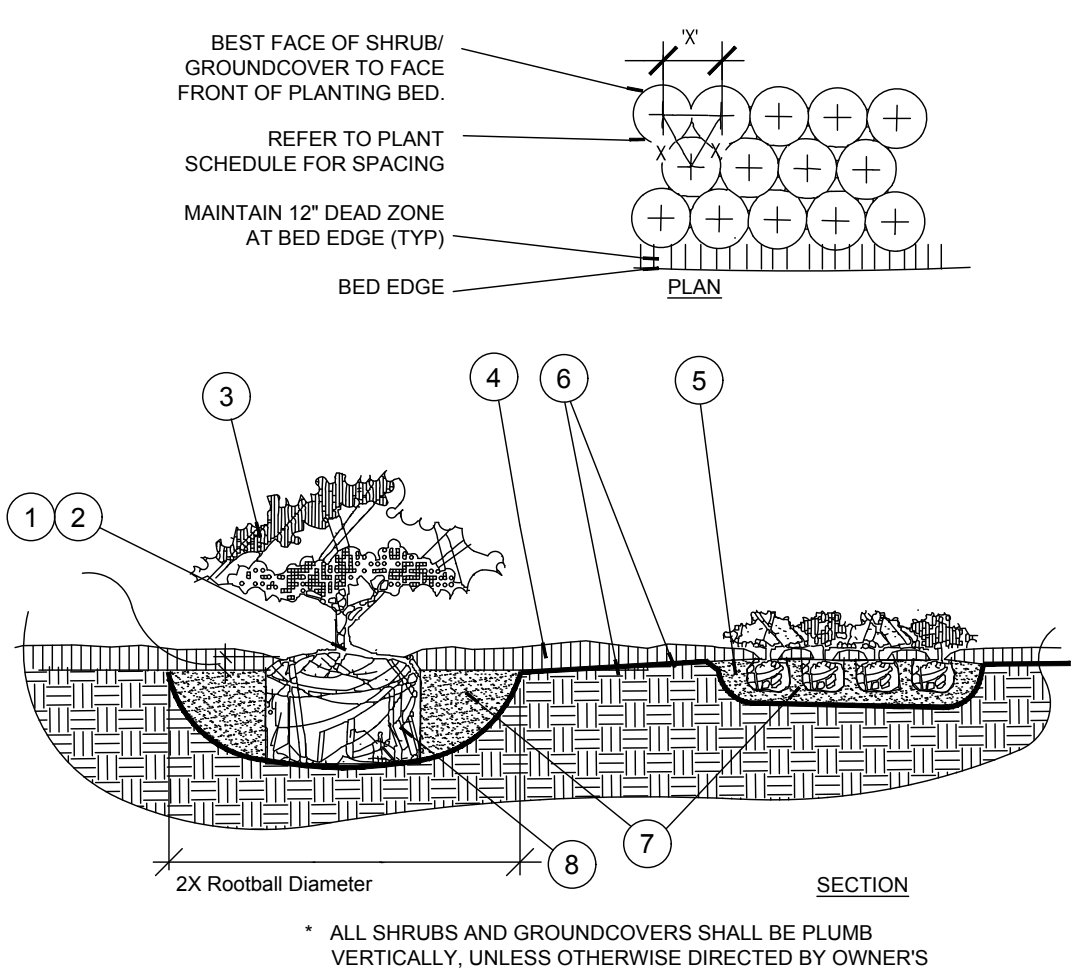

C Shrub / Groundcover Planting
PLAN / SECTION N.T.S.

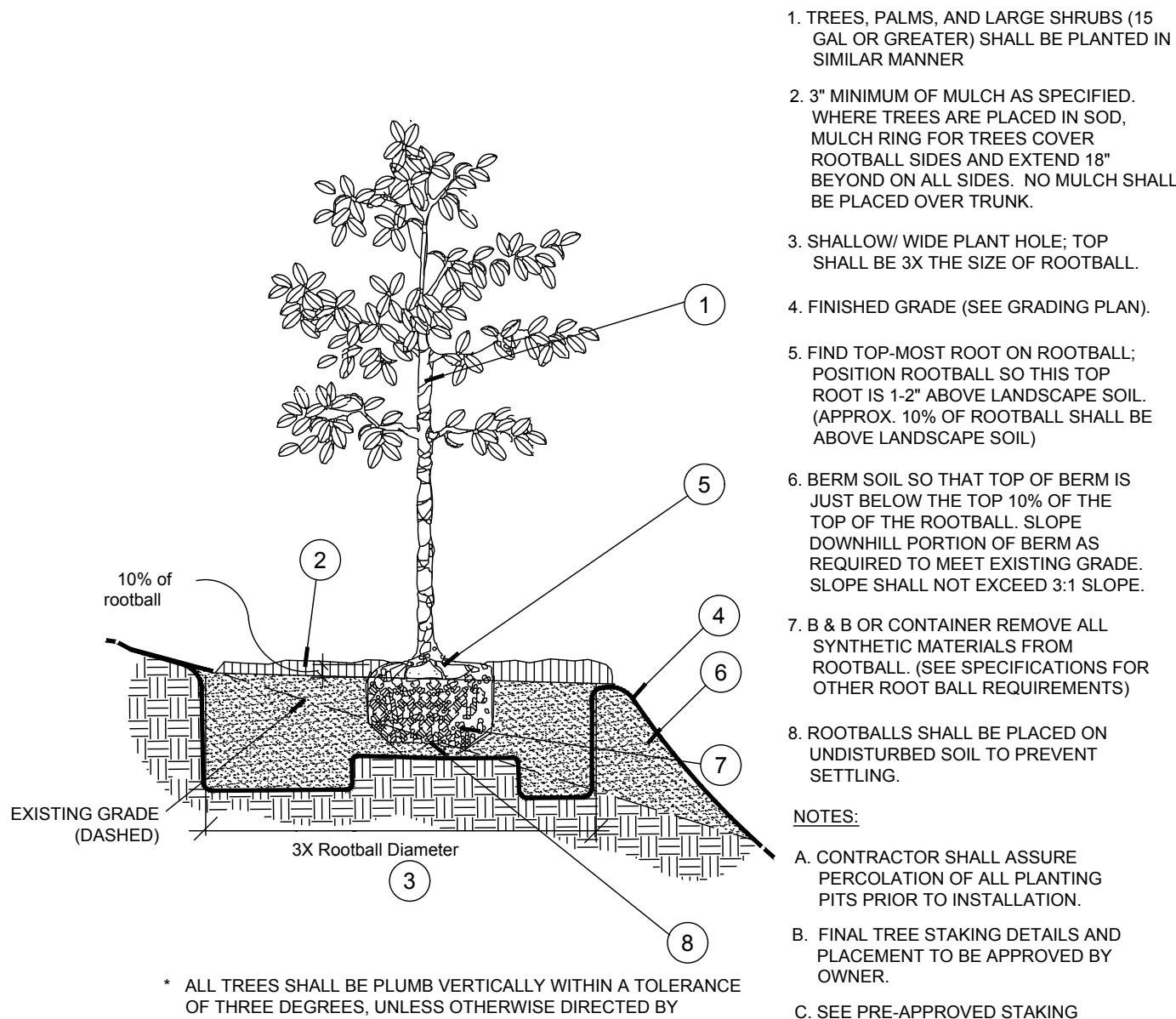

D Planting on a Slope
PLAN / SECTION N.T.S.

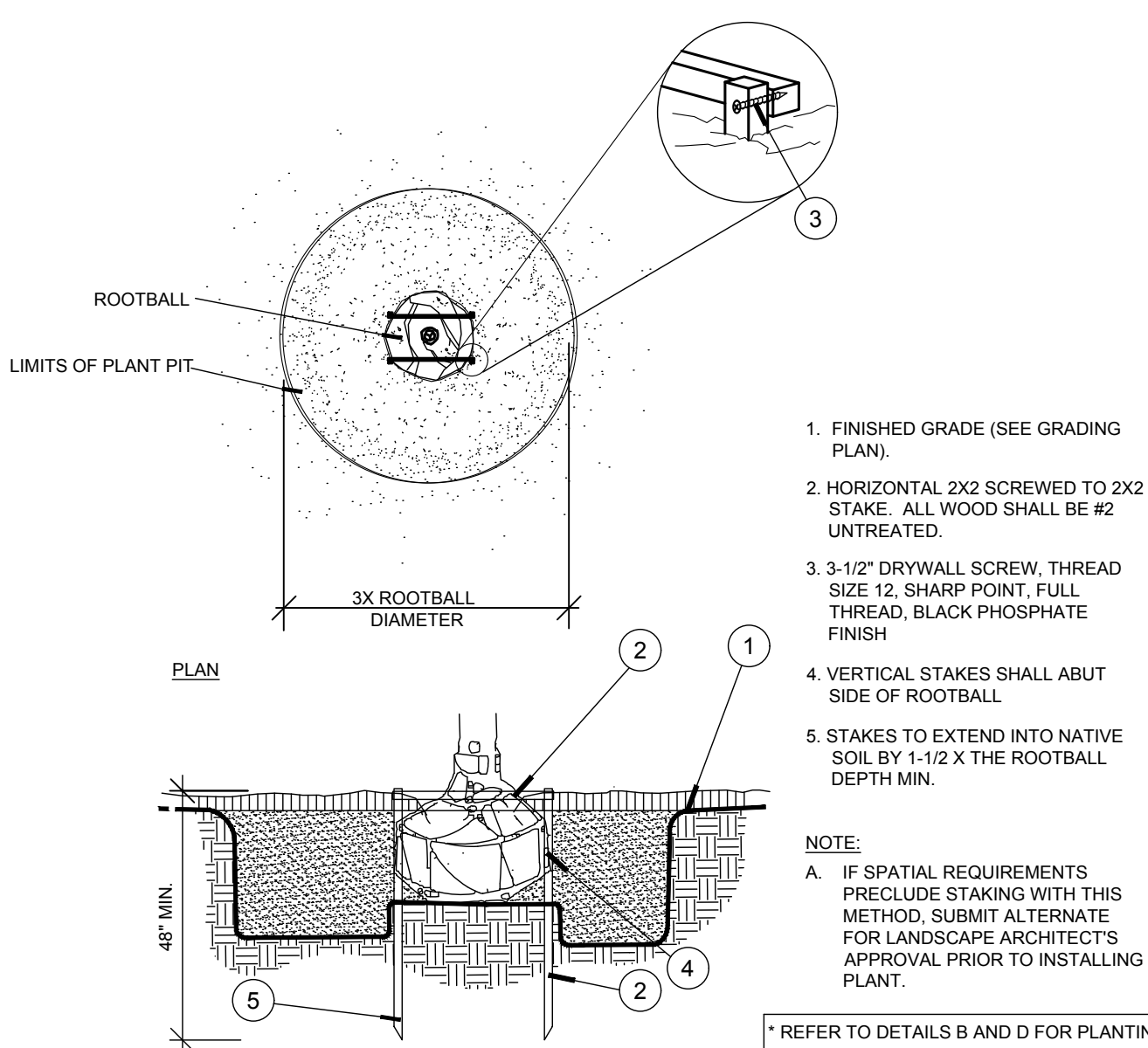

E Staking - up to 65 gal. or B&B to 3-1/2\"/>

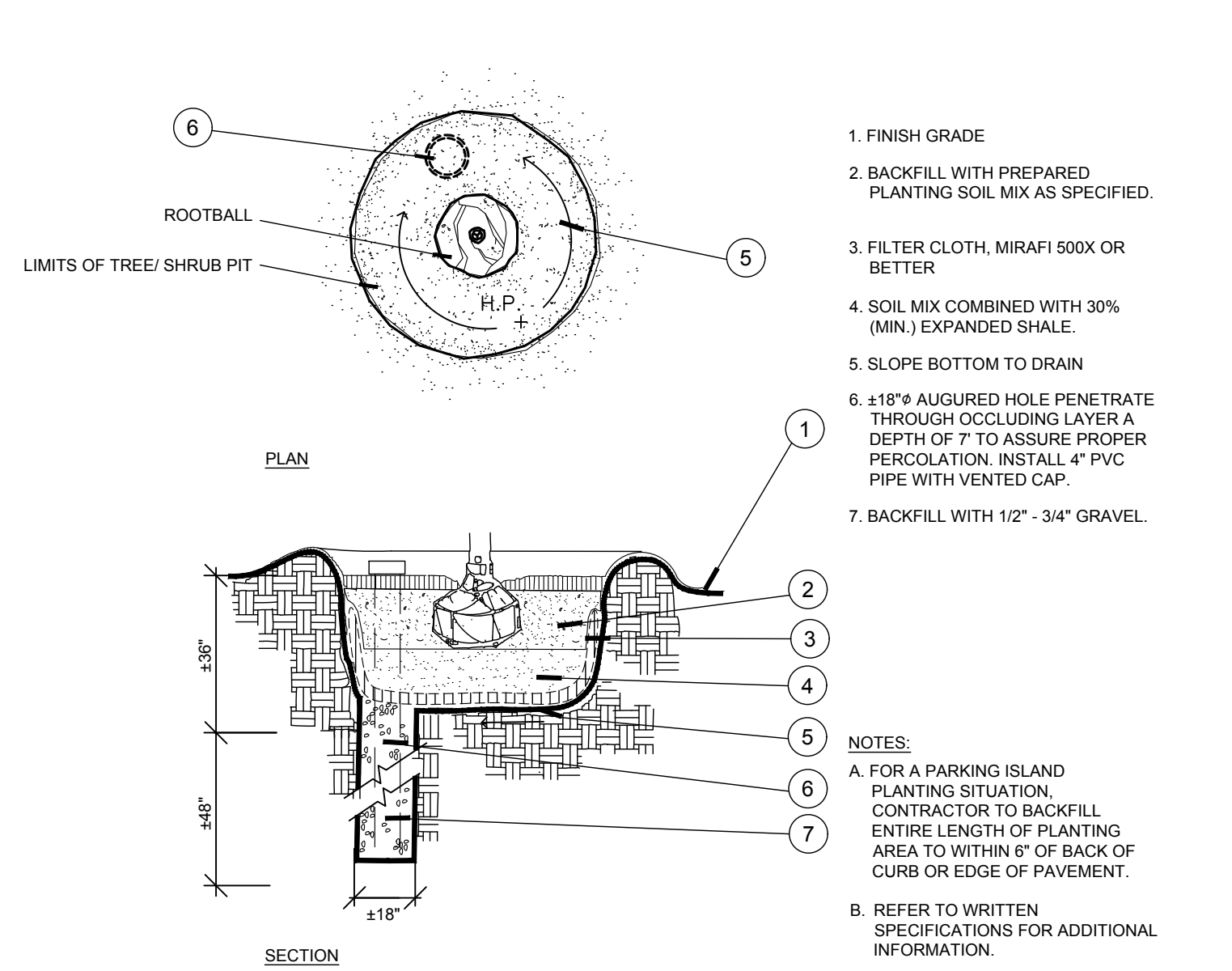

F Poor Drainage Condition
PLAN / SECTION N.T.S.

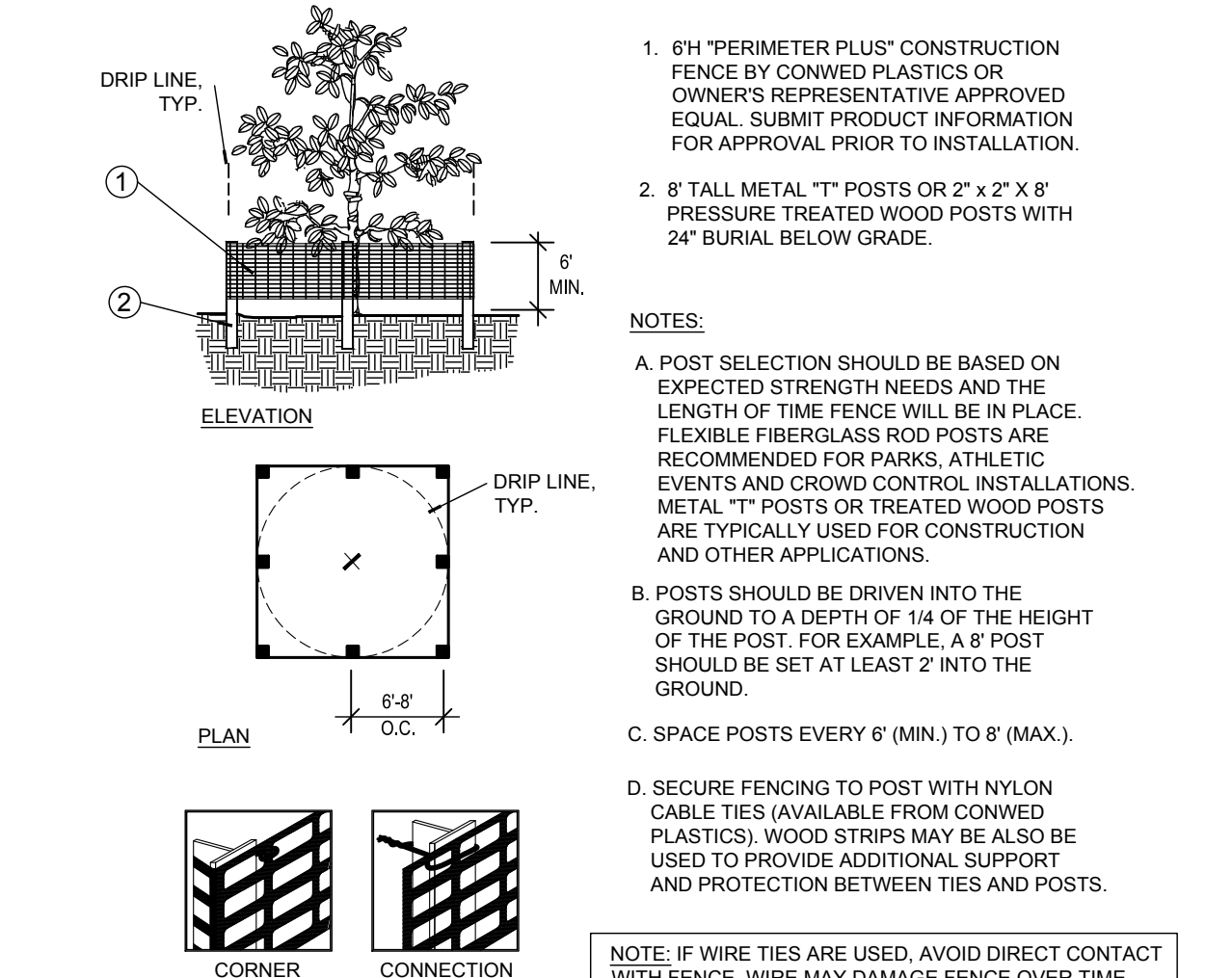

G Tree/Shrub Protector
SECTION N.T.S.

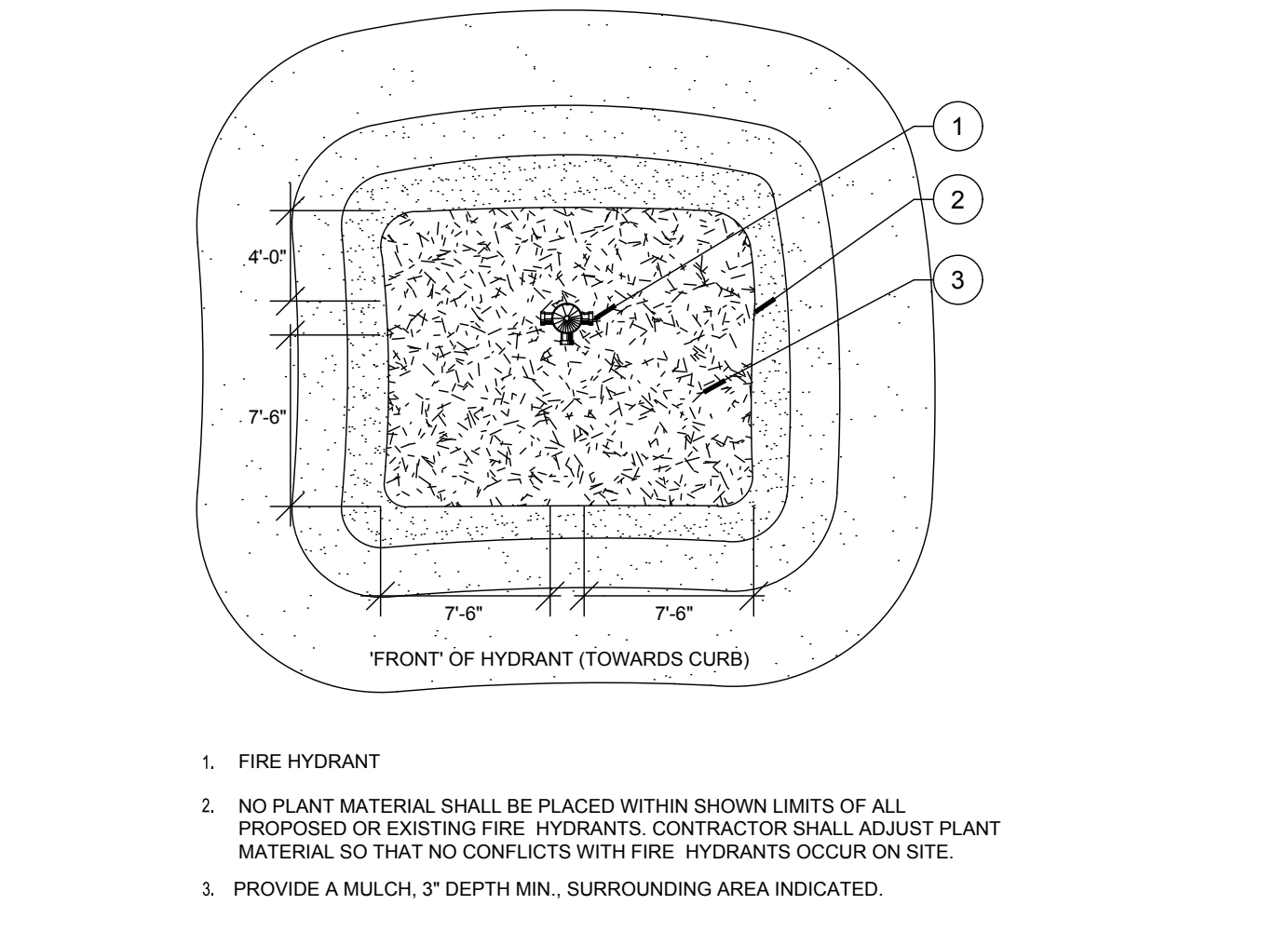

H Fire Hydrant Clear Zone
PLAN N.T.S.

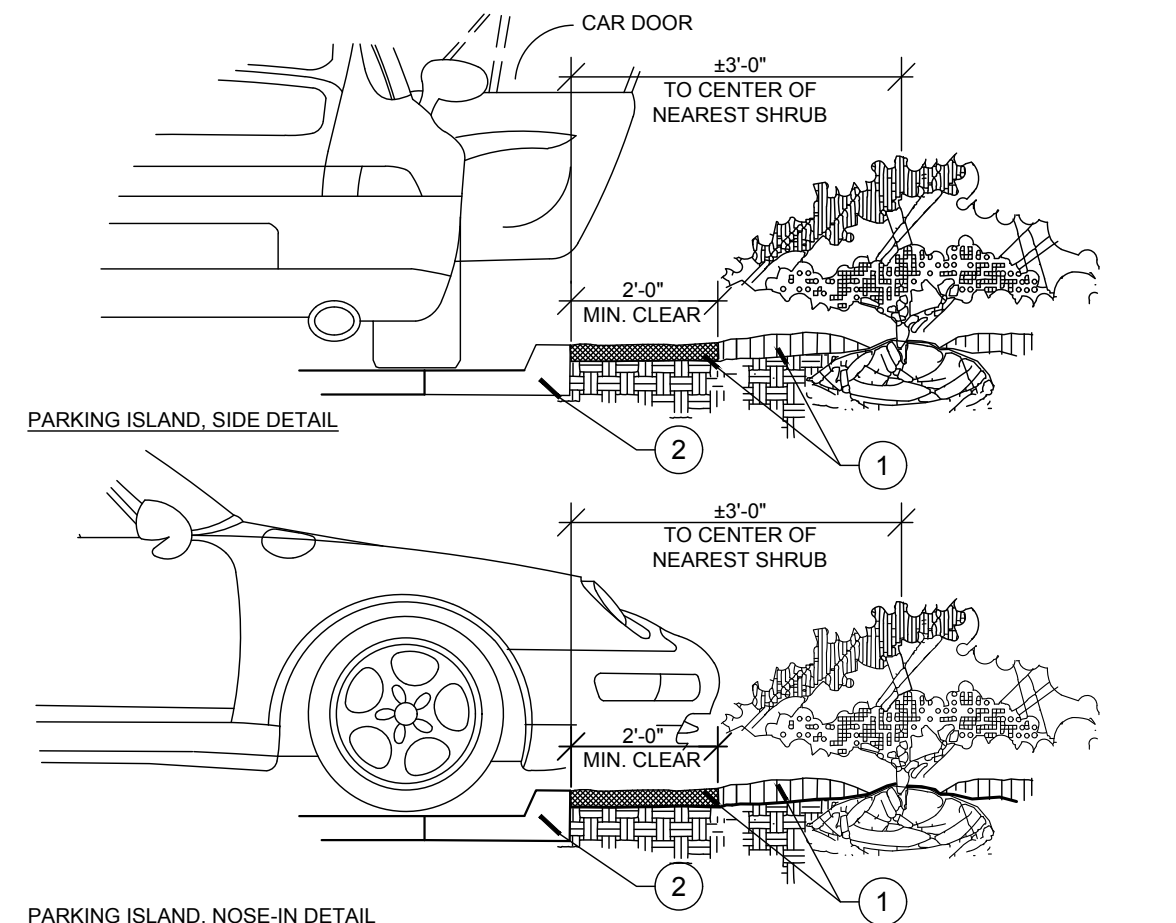

I Parking Space/Curb Planting
SECTION N.T.S.

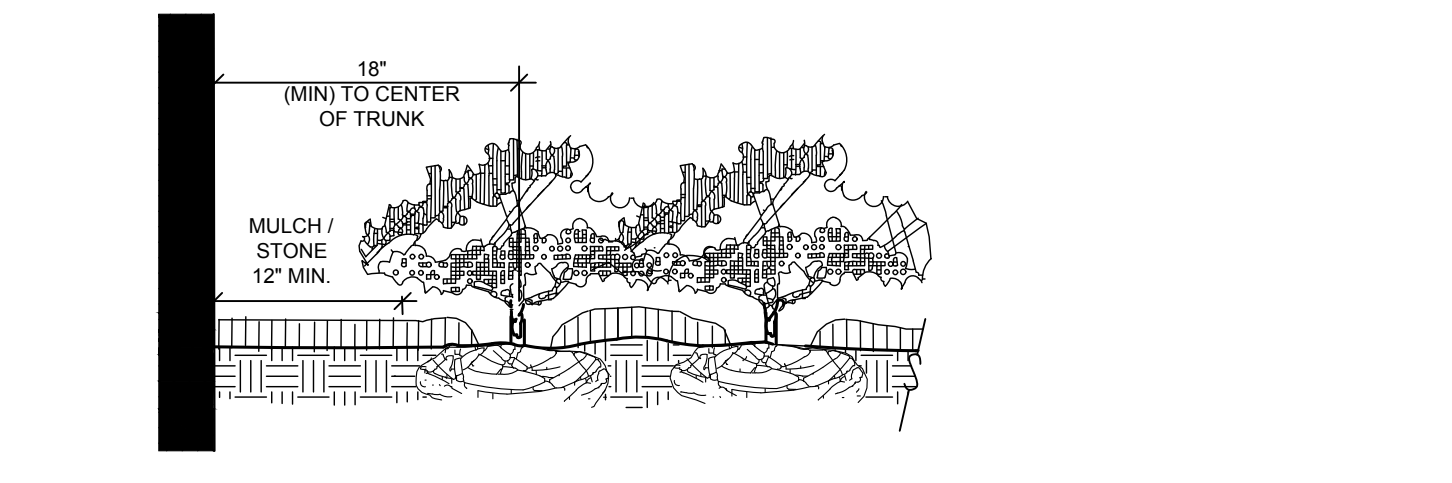

J Plantings Adjacent to Buildings/Walls
SECTION N.T.S.

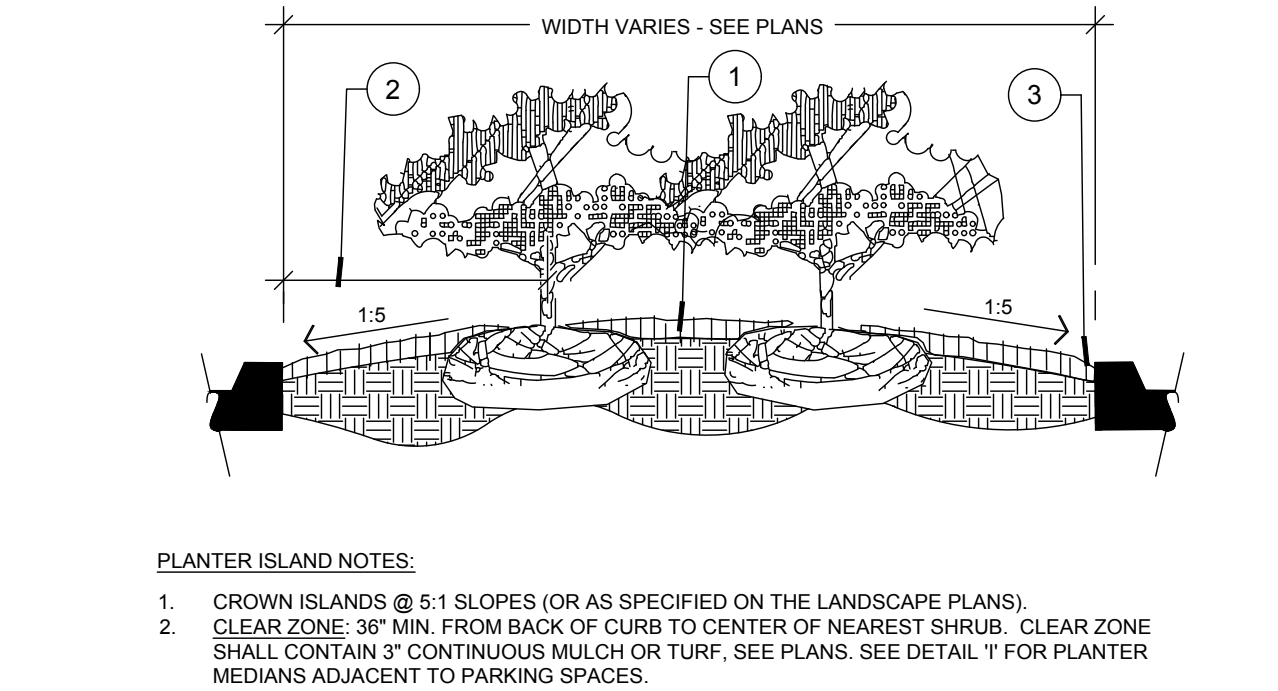

K Planted Parking Lot Islands / Medians
SECTION N.T.S.

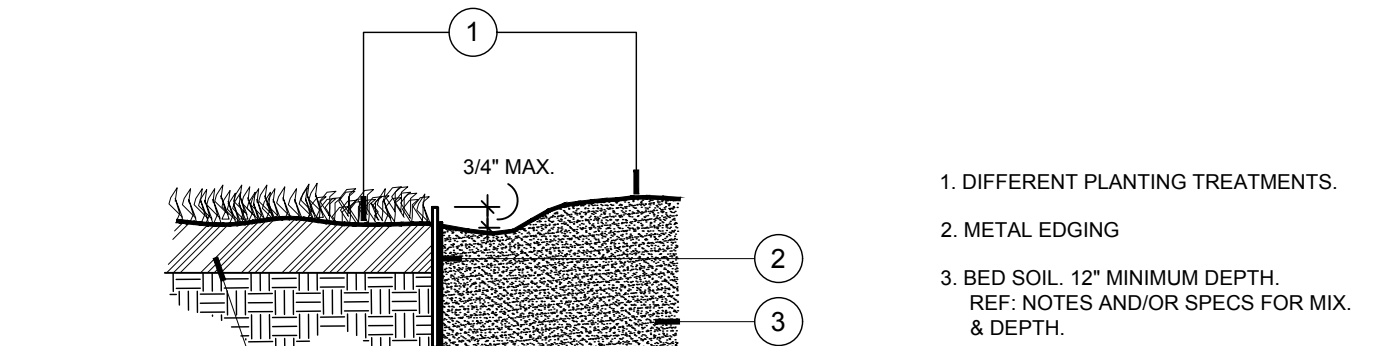

L Steel Edging
SECTION N.T.S.

NO.	REVISIONS	DATE

Kimley»Horn
 © 2017 KIMLEY-HORN AND ASSOCIATES, INC.
 1400 WOODCOCK FOREST DRIVE, SUITE 225
 THE WOODBRIDGE, VA 22191-3800
 PHONE: 703.771.2416
 FAX: 703.771.2418
 WWW.KIMLEY-HORN.COM

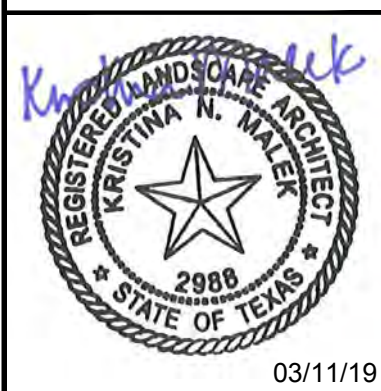

KHA PROJECT	067800501
DATE	03/11/2019
SCALE	AS SHOWN
DESIGNED BY	SEM
DRAWN BY	SEM
CHECKED BY	KNM

LANDSCAPE DETAILS

TRIAD GOSLING RETAIL
 HARRIS COUNTY
 TEXAS