

**Project Information:**

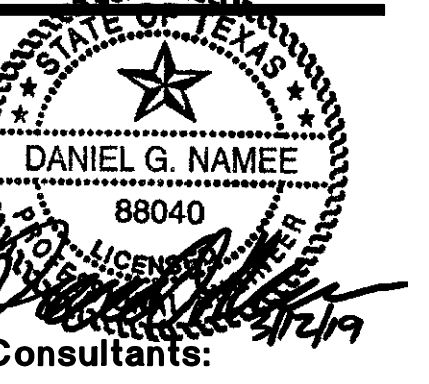

**DG**  
**eEngineering**  
 LLC  
 6019 Cerritos Houston, TX 77035  
 Ph) 713-729-6125 F) 713-729-6135  
 TBE FIRM # 7669

**SHOPS ON GOSLING**  
 RETAIL CENTER  
 SHELL BUILDING DEVELOPMENT  
 24309 GOSLING ROAD  
 SPRING, TEXAS 77389

**Sheet Title:**

**BUILDING "A"  
 PLUMBING PLAN**

**Issue:**

CD/PERMIT

**Issue Date:**

10 DECEMBER 2018 - SD  
 12 MARCH 2019 - CD/PERMIT

**Revision Date:**

**Sheet:**

**P1.01**

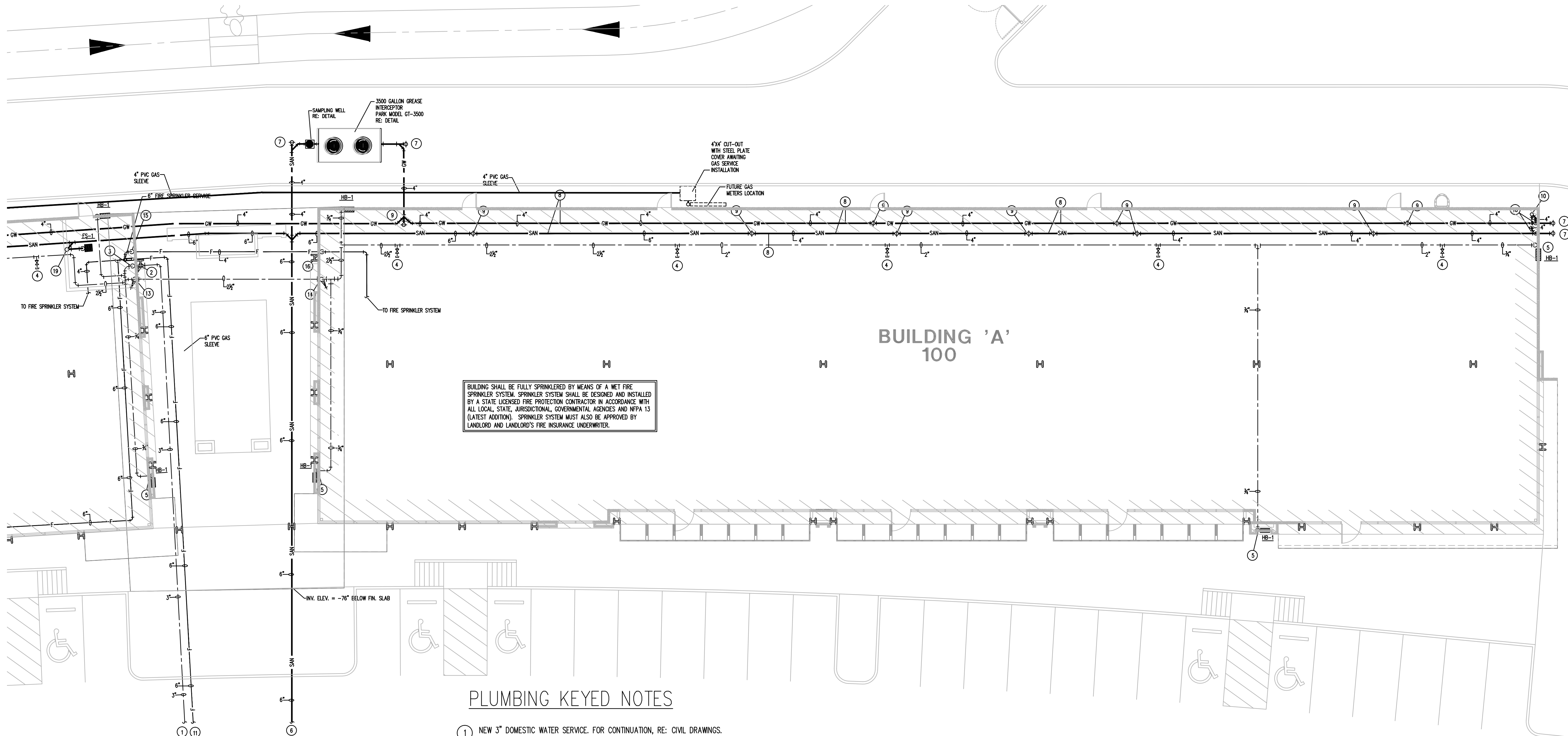

BUILDING SHALL BE FULLY SPRINKLERED BY MEANS OF A WET FIRE SPRINKLER SYSTEM. SPRINKLER SYSTEM SHALL BE DESIGNED AND INSTALLED BY A STATE LICENSED FIRE PROTECTION CONTRACTOR IN ACCORDANCE WITH ALL LOCAL, STATE, JURISDICTIONAL, GOVERNMENTAL AGENCIES AND NFPA 13 (LATEST ADDITION). SPRINKLER SYSTEM MUST ALSO BE APPROVED BY LANDLORD AND LANDLORD'S FIRE INSURANCE UNDERWRITER.

**PLUMBING KEYED NOTES**

- 1 NEW 3" DOMESTIC WATER SERVICE. FOR CONTINUATION, RE: CIVIL DRAWINGS.
- 2 DOMESTIC WATER SERVICE ENTRANCE. RE: DETAIL DWG. P-2.0
- 3 3" WATER LINE UP TO STRUCTURE.
- 4 1/2" WATER LINE, VALVED AND CAPPED FOR FUTURE TENANT CONNECTION. CONTRACTOR SHALL COORDINATE WITH CEILING HEIGHTS TO ASSURE PIPING IS ABOVE CEILING LINE.
- 5 3/4" C.W. LINE DOWN TO NON-FREEZE HOSE BIBB "HB-1".
- 6 NEW 6" SANITARY LINE TO SANITARY SEWER MAIN. FOR CONTINUATION RE: CIVIL DRAWINGS.
- 7 CLEANOUT TO GRADE. RE: DETAIL DWG. P-2.0
- 8 ROUTE NEW SANITARY AND GREASE WASTE SEWERS IN SLAB LEAVEOUT AREA.
- 9 4" FINISHED FLOOR CLEANOUT. RE: DETAIL DWG. P-2.0
- 11 NEW 6" FIRE SPRINKLER SERVICE. FOR CONTINUATION, RE: CIVIL DRAWINGS.
- 12 6" PVC GAS SLEEVE. CONTRACTOR SHALL TURN UP BOTH ENDS TO 12" ABOVE FIN. GRADE.
- 13 2 1/2" WATER LINE DOWN TO BELOW GRADE TO BUILDING "A". PROVIDE SHUT-OFF VALVE IN RISER
- 14 2 1/2" WATER LINE UP TO STRUCTURE. PROVIDE SHUT-OFF VALVE IN RISER.
- 15 4" FIRE SPRINKLER DOWN TO BELOW GRADE TO BUILDING "A".
- 16 4" FIRE SPRINKLER UP TO STRUCTURE.
- 17 6" PVC GAS SLEEVE FOR FUTURE GAS SERVICE. ROUTE FROM FUTURE GAS METER LOCATION TO UTILITY GAS MAIN. TURN UP TO ABOVE GRADE A MIN. OF 12" ABOVE GRADE AT BOTH ENDS. RE: CIVIL DRAWINGS FOR GAS MAIN LOCATION.
- 18 4" VENT UP
- 19 2" VENT THRU ROOF. RE: DETAIL DWG. P-2.0

**1 PLUMBING PLAN - BUILDING A**  
 3/32" = 1'-0"